

- DRAWING IS BASED ON TOPOGRAPHICAL SURVEY SUPPLIED BY AMEC FOSTER WHEELER (AFW) AND WAS LATER ENRICHED BY ADDITIONAL TOPOGRAPHICAL INFORMATION.
- EXISTING INFRASTRUCTURE IS INDICATED IN THE BACKGROUND OF THESE DRAWINGS. COLOURS SHOWN IN THESE DRAWINGS ARE INDICATIVE AND SHOULD NOT BE CONFUSED WITH THOSE OF FINISHED SURFACES.
- THE EXISTING HIGHWAY BOUNDARY IS SHOWN ON DRAWINGS AND INDICATED BY THE PURPLE DASHED LINE.
- THE RED LINE BOUNDARY IS SHOWN ON DRAWINGS AND INDICATED BY THE RED SOLID LINE. THE LOCATION OF NEW STATUTORY AUTHORITY COVERS WITHIN THE FOOTWAY AND CARRIAGEWAY WILL BE DETERMINED ONCE UTILITY DIVERSIONS ARE COMPLETED.
- FLUSH KERBS WILL BE INTRODUCED ALONG THE GRASSED SURFACE WATER CHANNEL. THESE WILL BE PAIRED WITH A 300MM HARD STRIP TO MAINTAIN THE INTEGRITY OF THE PROPOSED SWALES AND INCREASE SAFETY FOR ROAD USERS.
- REFER TO DRAWING UND-ACM-HGN-E2_EW_ZZ_ZZ-DR-CH-0101 FOR FURTHER INFORMATION ON THE PROPOSED UNDERPASS.
- PLEASE REFER TO INDIVIDUAL SERIES DRAWINGS FOR FURTHER DETAIL REGARDING THE STRUCTURES, DRAINAGE, LIGHTING, LANDSCAPE AND 3D DESIGN. INDICATIVE DESIGN ONLY IS DISPLAYED ON THESE GENERAL ARRANGEMENT DRAWINGS.
- SIGNS AND LIGHTING COLUMNS LOCATED IN THE SUP WILL NEED TO BE RELOCATED AS PART OF THE NEXT STAGE OF DESIGN SIGN LOCATION IS INDICATIVE. FURTHER DETAILS PROVIDED IN THE 1200 SERIES DRAWINGS.
- PHOTO-LUMINESCENT STUDIOS (ECO-DISK OR SIMILAR APPROVED) TO BE LAID AT REGULAR INTERVALS ALONG BOTH SIDES OF THE NEW SHARED USE FACILITY TO HIGHLIGHT THE EXTENTS OF THE PATH TO USERS DURING HOURS OF DARKNESS.
- VRS DESIGN IS BASED ON A RRRAP ASSESSMENT AND LOCAL ROAD RISK ASSESSMENT FOR HIGH AND LOW SPEED SECTIONS RESPECTIVELY. DESIGN IS SUBJECT TO CHANGE WITH DETAILS AND MANUFACTURE LENGTHS TO BE CONFIRMED AT A LATER DESIGN STAGE.
- FLOOD MITIGATION DESIGN IS EXCLUDED FROM THESE DRAWINGS DUE TO ONGOING MODELLING WORK.
- SCREENING TO REDUCE VISIBILITY TO THE RIGHT SHOULD BE AT LEAST 2m IN HEIGHT TO BLOCK THE VIEW OF ROAD USERS.
- IMPLEMENTATION OF PEDESTRIAN GUARD RAIL (PGR) AT THE TOUCAN CROSSING'S AT HORSEMERE LANE AND CASSINGTON JUNCTION IS SUBJECT TO A PGR ASSESSMENT.
- FOR FURTHER DETAILS ON LAND REQUIREMENTS AND OWNERSHIP PLEASE REFER TO BUS-ACM-HGN-E2_EW_ZZ_ZZ-DR-CH-0066-0087.

FOR PLANNING

ISSUE/REVISION

I/R	DATE	DESCRIPTION
P01	20/04/21	FIRST ISSUE
P02	25/06/21	SECOND ISSUE
P03	26/10/21	THIRD ISSUE
P04	11/11/21	FOURTH ISSUE
P05	16/11/21	ISSUED FOR PLANNING
P06	06/12/21	OCC/GH COMMENTS ADDRESSED
P07	13/12/21	VALIDATION COMMENTS

KEY PLAN

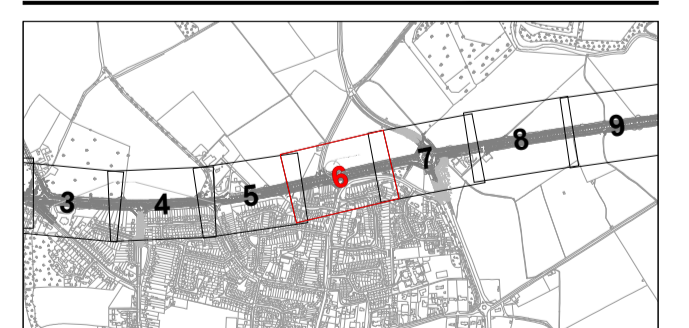

SHEET TITLE

**A40 IBL ELEMENT 2
GENERAL ARRANGEMENT
SHEET 6 OF 23**

SHEET NUMBER

Project Number	Originator	Volume	Revision
BUS	- ACM	- HGA	P07
E2_EW_ZZ_ZZ	- DR	- CH	- 0106
Location	I Type	I Role	I Number

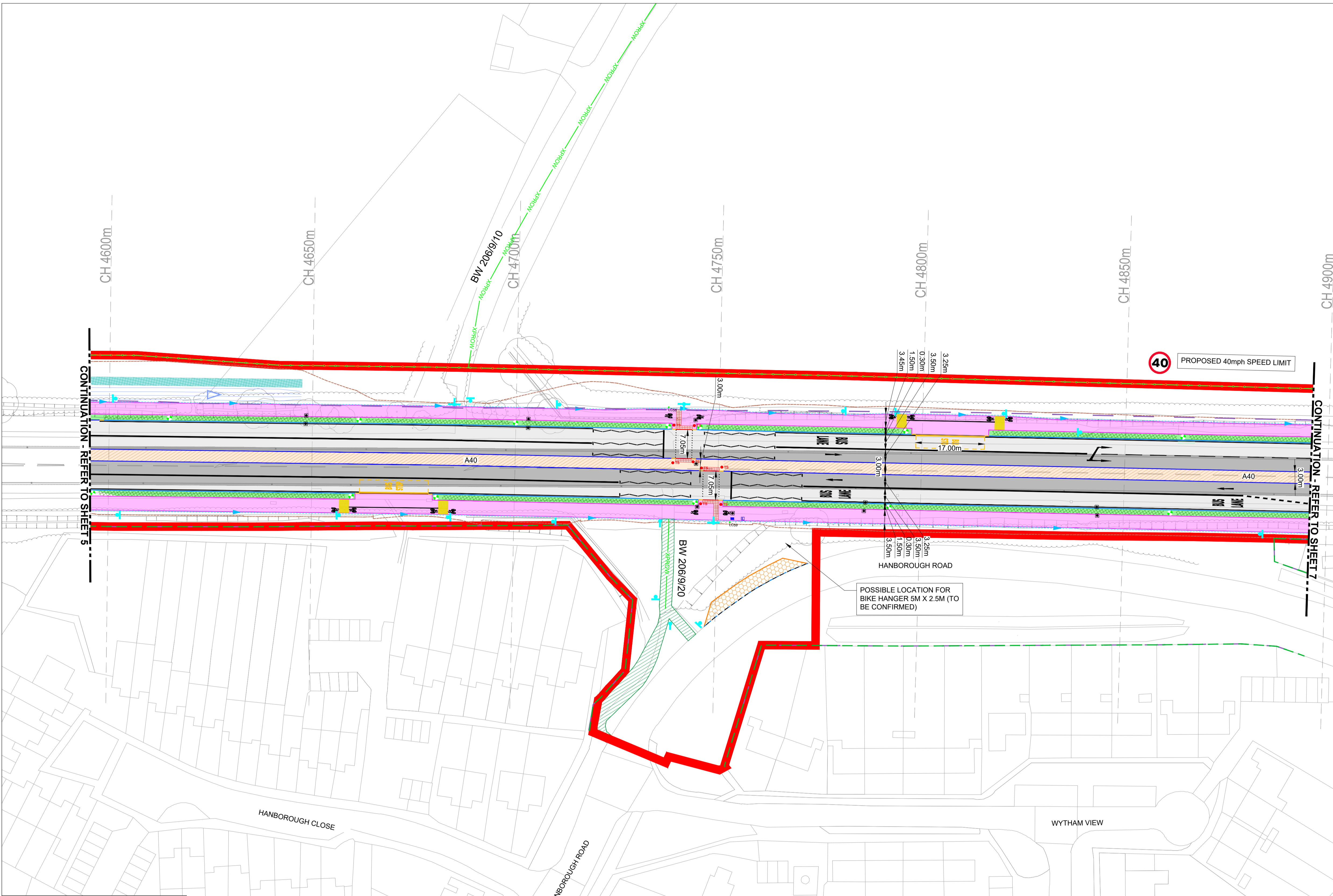

Reproduced from the Ordnance Survey mapping with the permission of the Controller of Her Majesty's Stationery Office © Crown Copyright. Unauthorised reproduction infringes Crown Copyright, and may lead to prosecution or civil proceedings. Oxfordshire County Council Licence No 100023343.

KEY

CHAINAGE STRING	PROPOSED FENCE LINE AT NEW HIGHWAY BOUNDARY LOCATIONS	PROPOSED 2m PLANTING AREA	PROPOSED MAINTENANCE LAY-BY. DETAILS TBC	PROPOSED YELLOW BUS STOP ROAD MARKINGS	PROPOSED TRAFFIC SIGNALS CONTROLLER AND ELECTRICITY SUPPLY PILLAR
EXISTING HIGHWAY BOUNDARY	PROPOSED 1.5m FULL HEIGHT FENCING	PROPOSED NCNS LINK LOCATION	PROPOSED CARRIAGEWAY RESURFACING DETAILS TBC.	PROPOSED WHITE ROAD MARKINGS. DETAILS TBC	PROPOSED DITCH AND DIRECTION OF FLOW
PROPOSED HIGHWAY BOUNDARY	PROPOSED 0.6m KNEE HEIGHT FENCING	PROPOSED SUBWAY PUMPING STATION	PROPOSED CARRIAGEWAY FULL DEPTH RECONSTRUCTION DETAILS TBC	PROPOSED TRAFFIC SIGNAL POLE	BACK OF FOOTWAY FILTER TRENCH WITH UNDERDRAIN
PROPOSED KERB 140mm UPSTAND. DETAILS TBC	EXISTING PUBLIC RIGHT OF WAY (FOOTPATH)	PROPOSED SHARED USE FACILITY / FOOTWAY	PROPOSED CORDUROY PAVING DETAILS TBC	PROPOSED LIGHTING COLUMN	PROPOSED GULLY GRATE
PROPOSED KERB 125mm UPSTAND. DETAILS TBC	EXISTING PUBLIC RIGHT OF WAY (RESTRICTED BYWAY)	PROPOSED TRAFFIC ISLAND (HARD SURFACE). DETAILS TBC	PROPOSED SPEEDTABLE - 25mm	PROPOSED TRAFFIC SIGN (PS) MOUNTED ON NEW POST	PROPOSED INSPECTION CHAMBER AND SILT TRAP DETAILS TBC
PROPOSED 45° SPLAY KERB DETAILS TBC	EXISTING PUBLIC RIGHT OF WAY (BRIDLEWAY)	PROPOSED TRAFFIC ISLAND (LANDSCAPING AREA). DETAILS TBC	PROPOSED SPEEDTABLE - 75mm	PROPOSED TRAFFIC SIGN (PS) MOUNTED BACK TO BACK ON NEW POST	PROPOSED BRIDGE ABUTMENTS DETAILS TBC
PROPOSED FLUSH KERB AT CROSSING (0.6mm). DETAILS TBC	PROPOSED COMBINED VRS AND FENCING	PROPOSED BUFF TACTILE PAVING	PROPOSED SPEEDTABLE - 30mm	PROPOSED WAY FINDING SIGN (PS) MOUNTED ON NEW POST	PROPOSED GATE DETAILS TBC
PROPOSED EDGING. DETAILS TBC	PROPOSED SCREENING	PROPOSED RED TACTILE PAVING	1000mm OVERRUN STRIP	PROPOSED REFLECTIVE BOLLARD	
PROPOSED EDGING AT VEHICLE CROSS OVER	PROPOSED VEHICLE RESTRAINT SYSTEM DETAILS TBC.	PROPOSED GRASS VERGE	BRIDGE PARAPETS	PROPOSED ROAD STUDS	
PROPOSED KERB 75mm UPSTAND. DETAILS TBC	PROPOSED EARTHWORKS EXTENTS	PROPOSED GRASSED SURFACE WATER CHANNEL OVERLAYING ATTENUATION TRENCH. DETAILS TBC	PROPOSED PEDESTRIAN DETERRENT PAVING	PROPOSED QUADRANT KERB. DETAILS TBC	
PROPOSED FLUSH KERB (0mm). DETAILS TBC	PROPOSED A40 SITE COMPOUND AREA	PROPOSED CONCRETE SUBWAY BOX - MODULAR CONSTRUCTION. DETAILS TBC	PROPOSED PAVEMENT RESURFACING	SUBWAY PUMP	
PROPOSED TRANSITION KERB. DETAILS TBC	PROPOSED RAMP DOWN TO SUBWAY - SOUTH SIDE. DETAILS TBC	PROPOSED RAMP DOWN TO SUBWAY - NORTH SIDE. DETAILS TBC	EXISTING CULVERT	EXISTING ELECTRIC SUB-STATION	
PROPOSED BULL-NOSED KERB. DETAILS TBC	PROPOSED LANDSCAPING / EARTHWORKS / RETAINING FEATURES. LOCATION INDICATIVE. DETAILS TBC	PROPOSED VEHICLE CROSS OVER	PROPOSED STRUCTURE WIDENING	PROPOSED SUBWAY ABUTMENTS AND WINGWALLS. DETAILS TBC	
REDLINE BOUNDARY	PROPOSED ADDITIONAL FOOTWAY / CYCLEWAY CONNECTION. DETAILS TBC	SSS/ISAC LOCATION		PROPOSED SHEET PILING	
				PROPOSED CHAMBER ACCESS POINT	

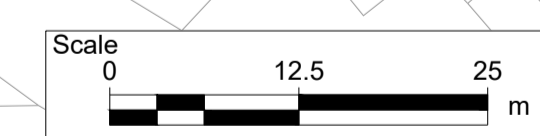

This drawing has been prepared for the use of AECOM's client. It may not be used, modified, reproduced or relied upon by third parties, except as agreed by AECOM or as required by law. AECOM accepts no responsibility, and denies any liability, whatsoever, to any party that uses or relies on this drawing without AECOM's express written consent. All measurements must be obtained from the stated dimensions.