

IBL HIGHWAYS DESIGN EXCLUDING DUALLING WESTERN ROUNDABOUT

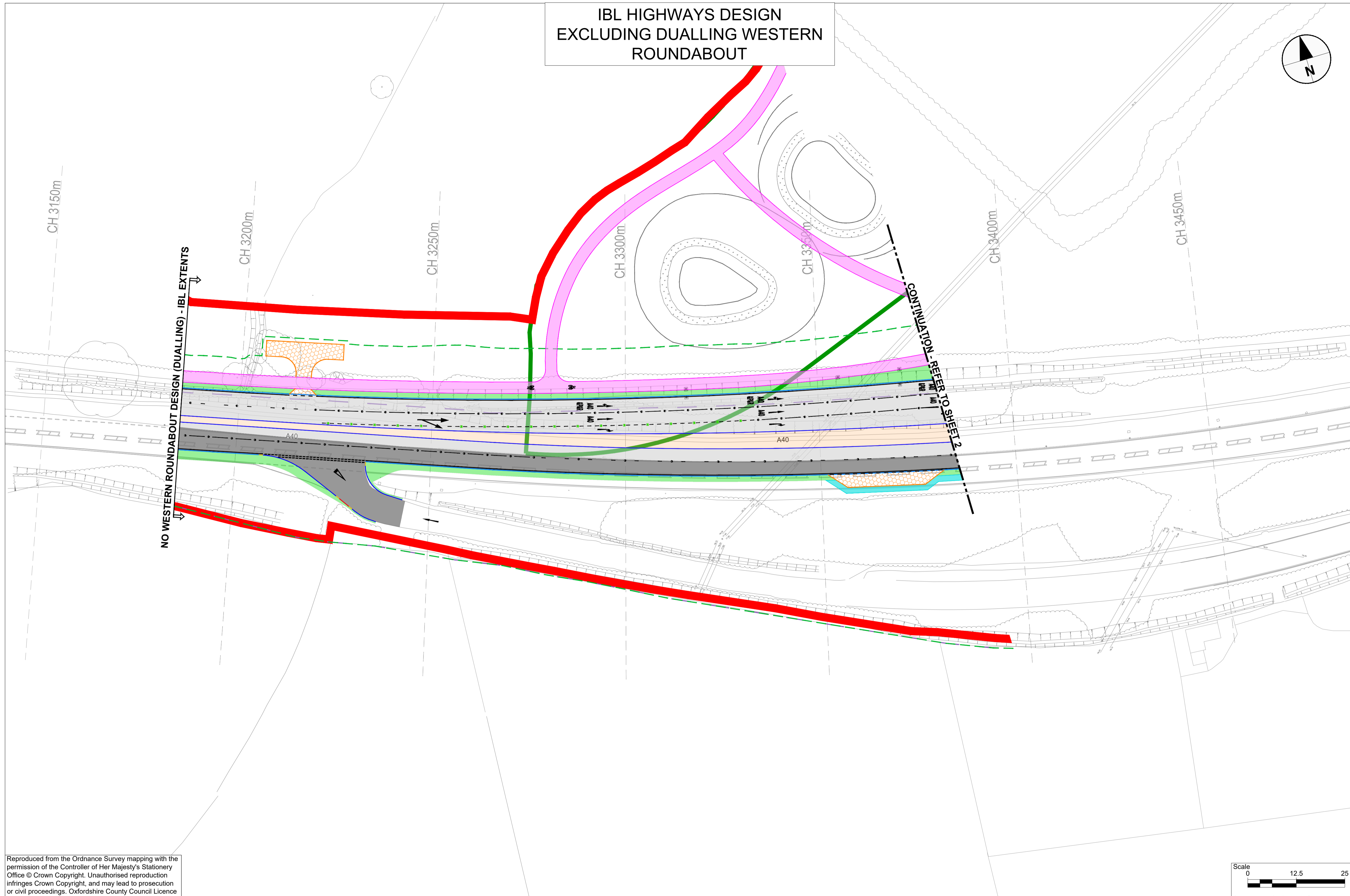
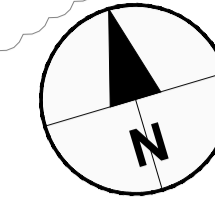

NO WESTERN ROUNDABOUT DESIGN (DUALLING) - IBL EXTENTS

CONTINUATION - REFER TO SHEET 2

This drawing has been prepared for the use of AECOM's client. It may not be used, modified, reproduced or relied upon by third parties, except as agreed by AECOM or as required by law. AECOM accepts no responsibility, and denies any liability, whatsoever, to any party that uses or relies on this drawing without AECOM's express written consent. Do not scale this document. All measurements must be obtained from the stated dimensions.

AECOM

PROJECT
A40 SMART CORRIDOR

PROJECT NUMBER
 60615257

CLIENT
OXFORDSHIRE COUNTY COUNCIL
 County Hall, New Road
 Oxford, OX1 1ND
 Tel: 01865 792422
 www.oxfordshire.gov.uk

CONSULTANT
 AECOM I&E Ltd.
 AECOM House, 63-77 Victoria Street
 St Albans, Herts AL1 3ER
 Tel: 01727 535000
 www.aecom.com

- NOTES**
- DRAWING IS BASED ON TOPOGRAPHICAL SURVEY SUPPLIED BY AMEC FOSTER WHEELER (AFW) AND WAS LATER ENRICHED BY ADDITIONAL TOPOGRAPHICAL INFORMATION.
 - EXISTING INFRASTRUCTURE IS INDICATED IN THE BACKGROUND OF THESE DRAWINGS. COLOURS SHOWN IN THESE DRAWINGS ARE INDICATIVE AND SHOULD NOT BE CONFUSED WITH THOSE OF FINISHED SURFACES.
 - THE EXISTING HIGHWAY BOUNDARY IS SHOWN ON DRAWINGS AND INDICATED BY THE PURPLE DASHED LINE.
 - THE RED LINE BOUNDARY IS SHOWN ON DRAWINGS AND INDICATED BY THE RED SOLID LINE.
 - THE LOCATION OF NEW STATUTORY AUTHORITY COVERS WITHIN THE FOOTWAY AND CARRIAGEWAY WILL BE DETERMINED ONCE UTILITY DIVERSIONS ARE COMPLETED.
 - FLUSH KERBS WILL BE INTRODUCED ALONG THE GRASSED SURFACE WATER CHANNEL. THESE WILL BE PAIRED WITH A 300MM HARD STRIP TO MAINTAIN THE INTEGRITY OF THE PROPOSED SWALES AND INCREASE SAFETY FOR ROAD USERS.
 - REFER TO DRAWING UND-ACM-HGN-E2_EW_ZZ-DR-CH-0101 FOR FURTHER INFORMATION ON THE PROPOSED UNDERPASS.
 - PLEASE REFER TO INDIVIDUAL SERIES DRAWINGS FOR FURTHER DETAIL REGARDING THE STRUCTURES, DRAINAGE, LIGHTING, LANDSCAPE AND 3D DESIGN. INDICATIVE DESIGN ONLY IS DISPLAYED ON THESE GENERAL ARRANGEMENT DRAWINGS.
 - SIGNS AND LIGHTING COLUMNS LOCATED IN THE SUP WILL NEED TO BE RELOCATED AS PART OF THE NEXT STAGE OF DESIGN SIGN LOCATION IS INDICATIVE. FURTHER DETAILS PROVIDED IN THE 1200 SERIES DRAWINGS.
 - PHOTO LUMINESCENT STUDS (ECO-DISK OR SIMILAR APPROVED) TO BE LAID AT REGULAR INTERVALS ALONG BOTH SIDES OF THE NEW SHARED USE FACILITY TO HIGHLIGHT THE EXTENTS OF THE PATH TO USERS DURING HOURS OF DARKNESS.
 - VRS DESIGN IS BASED ON A RRRAP ASSESSMENT AND LOCAL ROAD RISK ASSESSMENT FOR HIGH AND LOW SPEED SECTIONS RESPECTIVELY. DESIGN IS SUBJECT TO CHANGE WITH DETAILS AND MANUFACTURE LENGTHS TO BE CONFIRMED AT A LATER DESIGN STAGE.
 - FLOOD MITIGATION DESIGN IS EXCLUDED FROM THESE DRAWINGS DUE TO ONGOING MODELLING WORK.
 - SCREENING TO REDUCE VISIBILITY TO THE RIGHT SHOULD BE AT LEAST 2m IN HEIGHT TO BLOCK THE VIEW OF ROAD USERS.
 - IMPLEMENTATION OF PEDESTRIAN GUARD RAIL (PGR) AT THE TOUCAN CROSSING'S AT HORSEMERE LANE AND CASSINGTON JUNCTION IS SUBJECT TO A PGR ASSESSMENT.
 - FOR FURTHER DETAILS ON LAND REQUIREMENTS AND OWNERSHIP PLEASE REFER TO BUS-ACM-HGN-E2_EW_ZZ-DR-CH-0066-0087.

FOR PLANNING

ISSUE/REVISION

| I/R | DATE | DESCRIPTION |
|-----|----------|---------------------|
| P01 | 13/12/21 | ISSUED FOR PLANNING |

Reproduced from the Ordnance Survey mapping with the permission of the Controller of Her Majesty's Stationery Office © Crown Copyright. Unauthorised reproduction infringes Crown Copyright, and may lead to prosecution or civil proceedings. Oxfordshire County Council Licence No 100023343.

KEY

| | | | | | |
|--|---|---|--|---|---|
| <ul style="list-style-type: none"> CHAINAGE STRING EXISTING HIGHWAY BOUNDARY PROPOSED HIGHWAY BOUNDARY PROPOSED KERB 140mm UPSTAND. DETAILS TBC PROPOSED KERB 125mm UPSTAND. DETAILS TBC PROPOSED 45° SPLAY KERB DETAILS TBC PROPOSED FLUSH KERB AT CROSSING (0.6mm). DETAILS TBC PROPOSED EDGING. DETAILS TBC PROPOSED EDGING AT VEHICLE CROSS OVER PROPOSED KERB 75mm UPSTAND. DETAILS TBC PROPOSED FLUSH KERB (0mm). DETAILS TBC PROPOSED TRANSITION KERB. DETAILS TBC PROPOSED BULL-NOSED KERB. DETAILS TBC REDLINE BOUNDARY | <ul style="list-style-type: none"> PROPOSED FENCE LINE AT NEW HIGHWAY BOUNDARY LOCATIONS PROPOSED 1.5m FULL HEIGHT FENCING PROPOSED 0.6m KNEE HEIGHT FENCING EXISTING PUBLIC RIGHT OF WAY (FOOTPATH) EXISTING PUBLIC RIGHT OF WAY (RESTRICTED BYWAY) EXISTING PUBLIC RIGHT OF WAY (BRIDLEWAY) PROPOSED COMBINED VRS AND FENCING PROPOSED SCREENING PROPOSED VEHICLE RESTRAINT SYSTEM DETAILS TBC. PROPOSED EARTHWORKS EXTENTS PROPOSED EDGING AT VEHICLE CROSS OVER PROPOSED KERB 75mm UPSTAND. DETAILS TBC PROPOSED FLUSH KERB (0mm). DETAILS TBC PROPOSED TRANSITION KERB. DETAILS TBC PROPOSED BULL-NOSED KERB. DETAILS TBC REDLINE BOUNDARY | <ul style="list-style-type: none"> PROPOSED 2m PLANTING AREA PROPOSED NCNS LINK LOCATION PROPOSED SUBWAY PUMPING STATION PROPOSED SHARED USE FACILITY / FOOTWAY PROPOSED TRAFFIC ISLAND (HARD SURFACE). DETAILS TBC PROPOSED TRAFFIC ISLAND (LANDSCAPING AREA). DETAILS TBC PROPOSED BUFF TACTILE PAVING PROPOSED RED TACTILE PAVING PROPOSED GRASS VERGE PROPOSED GRASSED SURFACE WATER CHANNEL OVERLAYING ATTENUATION TRENCH. DETAILS TBC PROPOSED CONCRETE SUBWAY BOX - MODULAR CONSTRUCTION. DETAILS TBC PROPOSED RAMP DOWN TO SUBWAY - SOUTH SIDE. DETAILS TBC PROPOSED LANDSCAPING / EARTHWORKS / RETAINING FEATURES. LOCATION INDICATIVE. DETAILS TBC PROPOSED RAMP DOWN TO SUBWAY - NORTH SIDE. DETAILS TBC PROPOSED VEHICLE CROSS OVER SSSIS/AC LOCATION | <ul style="list-style-type: none"> PROPOSED MAINTENANCE LAY-BY. DETAILS TBC PROPOSED CARRIAGEWAY RESURFACING DETAILS TBC. PROPOSED CARRIAGEWAY FULL DEPTH RECONSTRUCTION DETAILS TBC PROPOSED SPEEDTABLE - 25mm PROPOSED SPEEDTABLE - 75mm PROPOSED SPEEDTABLE - 30mm 1000mm OVERRUN STRIP BRIDGE PARAPETS PROPOSED PEDESTRIAN DETERRENT PAVING PROPOSED PAVEMENT RESURFACING EXISTING CULVERT PROPOSED STRUCTURE WIDENING | <ul style="list-style-type: none"> PROPOSED YELLOW BUS STOP ROAD MARKINGS PROPOSED WHITE ROAD MARKINGS. DETAILS TBC TS PROPOSED TRAFFIC SIGNAL POLE LC PROPOSED LIGHTING COLUMN PROPOSED TRAFFIC SIGN (PS) MOUNTED ON NEW POST PROPOSED TRAFFIC SIGN (PS) MOUNTED BACK TO BACK ON NEW POST PROPOSED WAY FINDING SIGN (PS) MOUNTED ON NEW POST PROPOSED REFLECTIVE BOLLARD PROPOSED ROAD STUDS PROPOSED QUADRANT KERB. DETAILS TBC SUBWAY PUMP EXISTING ELECTRIC SUB-STATION PROPOSED SUBWAY ABUTMENTS AND WINGWALLS. DETAILS TBC PROPOSED SHEET PILING PROPOSED CHAMBER ACCESS POINT | <ul style="list-style-type: none"> PROPOSED TRAFFIC SIGNALS CONTROLLER AND ELECTRICITY SUPPLY PILLAR PROPOSED DITCH AND DIRECTION OF FLOW BACK OF FOOTWAY FILTER TRENCH WITH UNDERDRAIN PROPOSED GULLY GRATE PROPOSED INSPECTION CHAMBER AND SILT TRAP DETAILS TBC PROPOSED BRIDGE ABUTMENTS DETAILS TBC PROPOSED GATE DETAILS TBC |
|--|---|---|--|---|---|

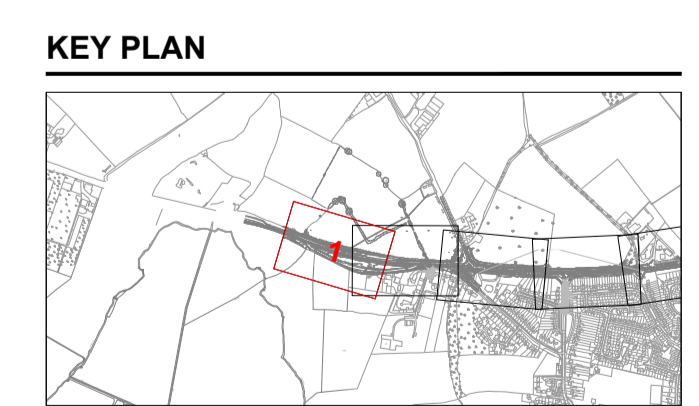
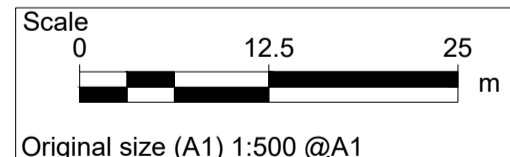

SHEET TITLE
A40 IBL ELEMENT 2
GENERAL ARRANGEMENT
SHEET 1 OF 2

SHEET NUMBER

| | | | |
|----------------|--------------|----------|----------|
| Project Number | 1 Originator | 1 Volume | Revision |
| BUS | - ACM | - HGA | P01 |
| E2_EW_ZZ_ZZ | - DR | - CH | - 0125 |
| Location | 1 Type | 1 Role | 1 Number |