

IT IS ASSUMED THAT ALL WORKS ON THIS DRAWING WILL BE CARRIED OUT BY A COMPETENT CONTRACTOR WORKING, WHERE APPROPRIATE, TO AN APPROPRIATE METHOD STATEMENT.

THIS DRAWING IS TO BE USED ONLY FOR THE PURPOSE OF ISSUE THAT IT WAS ISSUED FOR AND IS SUBJECT TO AMENDMENT.

- NOTES:**
- ALL DIMENSIONS ARE IN METRES UNLESS OTHERWISE STATED
 - DO NOT SCALE FROM DRAWING.
 - THE INFORMATION ON THIS PLAN IS GIVEN WITHOUT OBLIGATION OR WARRANTY. NO LIABILITY OF ANY KIND WHATSOEVER IS ACCEPTED BY AECOM FOR ANY ERRORS OR OMISSIONS.
 - DRAWING IS BASED ON ORDNANCE SURVEY MAPPING AND TOPOGRAPHICAL SURVEY
 - ITEMS IN GREY (APART FROM SOLID HATCHING) REPRESENT EXISTING INFRASTRUCTURE AND ARE TO REMAIN UNLESS STATED OTHERWISE.
 - PONDS INDICATED ON DRAWINGS ARE ALSO REFERRED TO AS MARSH AND WET GRASSLAND WITHIN LANDSCAPE DRAWINGS.
 - SEE LANDSCAPE DRAWINGS FOR THE NEW LANDSCAPE FEATURES AND EXISTING TREE RETENTION DETAILS.

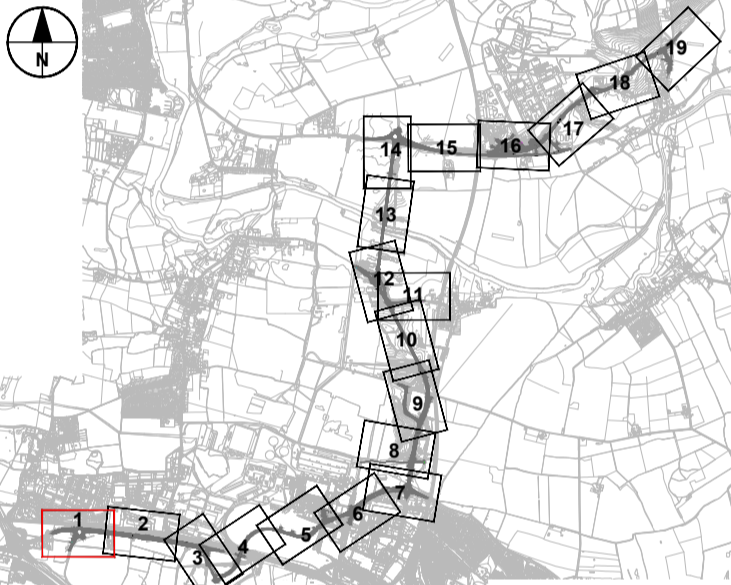
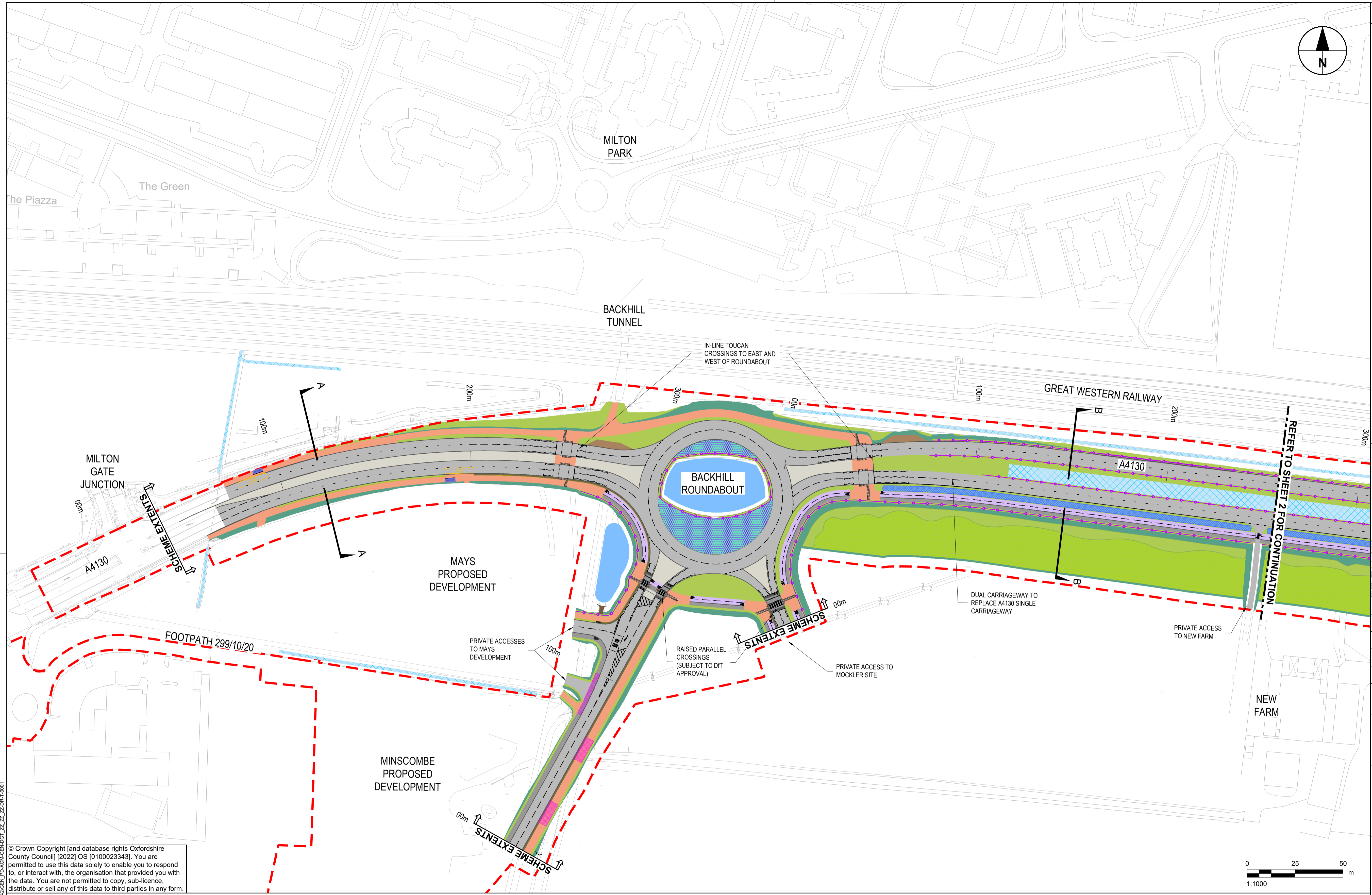
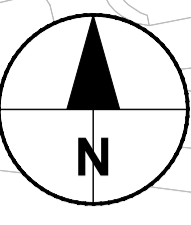

Version	By	Date	Check	Suffix
FIRST VERSION	AZ	21/07/21	KC	P01
SECOND VERSION	AZ	09/09/21	AGB	P02
THIRD VERSION	RBF	13/06/22	AA	P03
REVISION DETAILS				

Purpose of issue
SUITABLE FOR APPROVAL

Client
OXFORDSHIRE COUNTY COUNCIL

Project Title
DIDCOT GARDEN TOWN HOUSING INFRASTRUCTURE FUND (HIF 1)

Drawing Title
A4130 WIDENING GENERAL ARRANGEMENT SHEET 1 OF 19

Designed	Drawn	Checked	Approved	Date
AZ	RBF	AA	AGB	13/06/22

Internal Project No. 60632497
Scale @ A1 1:1000
Discipline Town & Country Planner

THIS DOCUMENT HAS BEEN PREPARED PURSUANT TO AND SUBJECT TO THE TERMS OF AECOM'S APPOINTMENT BY ITS CLIENT. AECOM ACCEPTS NO LIABILITY FOR ANY USE OF THIS DOCUMENT OTHER THAN BY ITS ORIGINAL CLIENT OR FOLLOWING AECOM'S EXPRESS AGREEMENT TO SUCH USE, AND ONLY FOR THE PURPOSES FOR WHICH IT WAS PREPARED AND PROVIDED.

Work Package ID	Volume	Type	Number	Rev
GEN_PD-ACM-GEN-DGT_ZZ_ZZ_ZZDR-T	-0001			P03

© Crown Copyright [and database rights Oxfordshire County Council] [2022] OS [0100023343]. You are permitted to use this data solely to enable you to respond to, or interact with, the organisation that provided you with the data. You are not permitted to copy, sub-licence, distribute or sell any of this data to third parties in any form.

KEY

	FOOTWAY		POND
	CYCLEWAY		GRASSED SURFACE WATER CHANNEL
	SHARED USE FOOTWAY		WATER BODY
	CARRIAGEWAY		WETLAND AREA
	OVERRUN AREA		SWALE / FILTER DRAIN
	GRASS VERGE / LANDSCAPED AREA		PROPOSED DITCH
	EMBANKMENT / LANDSCAPED AREA		EXISTING DITCH
	BUFFER STRIP		FLOOD ATTENUATION AREA
	CLEAR ZONE		VEHICLE CROSS OVER
	CUTTING		HEADWALL
	TRAFFIC ISLAND		WATERCOURSE
	MAINTENANCE ACCESS / MAINTENANCE LAY-BY		NOISE BARRIER
	ROAD MARKINGS		VEHICLE RESTRAINT SYSTEM BARRIER
	REDLINE BOUNDARY		BRIDGE STRUCTURE

File Name: C:\WORKING\GEN-DGT_ZZ_ZZ_ZZDR-T_ZZ_ZZ_ZZDR-T_0001
 Plot Date: 29 June 2022 15:27:17
 File Name: C:\WORKING\GEN-DGT_ZZ_ZZ_ZZDR-T_ZZ_ZZ_ZZDR-T_0001