

Divisions: Eynsham

CABINET MEMBER FOR ENVIRONMENT– 19 MARCH 2015

PROPOSED ZEBRA CROSSING – WITNEY ROAD, EYNSHAM

Report by Deputy Director for Environment & Economy (Commercial)

Introduction

1. This report considers responses to a consultation for a proposed zebra crossing on Witney Road, Eynsham.

Background

2. Witney Road, Eynsham is an unclassified road linking the centre of Eynsham to the A40. As well as several housing estates bordering it, Bartholomew School (a large secondary academy school with 1200 plus pupils) is accessed off Witney Road. Traffic surveys show that the road carries approximately 4000 vehicles per day, with approximately 475 vehicles during the morning peak hour.
3. Approximately 170 pupils commute by bus from the Oxford direction, alighting on the north bound side of the carriageway, needing to cross Witney Road to access the school. In addition up to 150 pupils have to cross Witney Road daily to access the sports field on the west side of the road. The need for a crossing at this point to give some control to the way children cross and then access the school has been reported in the local media.
4. The location of the proposed crossing is shown in Annex 1.

Consultation

5. In January 2015 formal consultation took place on the proposal. As part of the consultation the Council wrote to local residents and businesses directly affected by the proposal and public notices were displayed on site. Twenty six responses were received of which sixteen are in support of the crossing, with seven objections, the remaining three provided comments. Of the seven objectors most are residents in close proximity to the crossing. Annex 2 summarises the responses received with the key points discussed below (copies of all the responses are available in the Members Resource Room).
6. The school and County Councillor Charles Mathew are in full support of the scheme, and both West Oxfordshire District Council and Thames Valley Police do not object to the crossing.
7. Eynsham Parish Council does not support the scheme in its current location, but suggests that the crossing is located twenty metres further south.

CMDE5

8. The residents of the house adjacent to the proposed crossing strongly object on the grounds that the facility is only required for a small portion of the day (to facilitate crossing for the school) yet the presence of the zig-zag markings and bus stop clearway will prevent anyone from stopping outside the house at any time. They feel that the crossing will make egress from their driveway even more difficult than it is at present.
9. Two objectors consider that the crossing is unnecessary as the pupils are old enough to be able to cross the road safely, and therefore the crossing is a waste of money; others suggest that introducing a 20 mph speed limit throughout the area would give greater safety benefits; and several suggest that the crossing location might not be the most appropriate.
10. In response to the objections that the crossing should be relocated to the south of the proposed location, this option has been carefully assessed and a safety audit carried out. However the alternative location was considered unsafe and detrimental to the usage of the zebra crossing because of the need to keep the bus stops in close proximity to the school.
11. With regard to the effect on the adjacent dwelling, it is acknowledged that the proposed zig-zag markings and bus stop clearway will prevent vehicles stopping on Witney Road outside the property. However alternative kerbspace is available very close by at the rear of the property on Thornbury Road.
12. On the matter of the need for the crossing, it is acknowledged that secondary-age children should be fully aware when crossing a busy road. However the inevitable vehicle and pedestrian congestion that occurs outside a school at the beginning and end of the day can lead to a loss of concentration by pupils and drivers alike – a formal crossing facility provides a clear place to cross.

Financial and Staff Implications (including Revenue)

13. The cost of the proposed work will be approximately £35,000 including fees and will be funded by s106 developer monies, of which £22,500 is already available, the remaining funds are expected within the next 12 months.

RECOMMENDATION

14. **The Cabinet Member for Environment is RECOMMENDED to approve the proposed zebra crossing on Witney Road.**

MARK KEMP

Deputy Director for Environment & Economy (Commercial)

Background papers: Consultation documentation
Consultation Responses

Contact Officers: Paul Durham 01865 815074

CMDE5

Annex 1

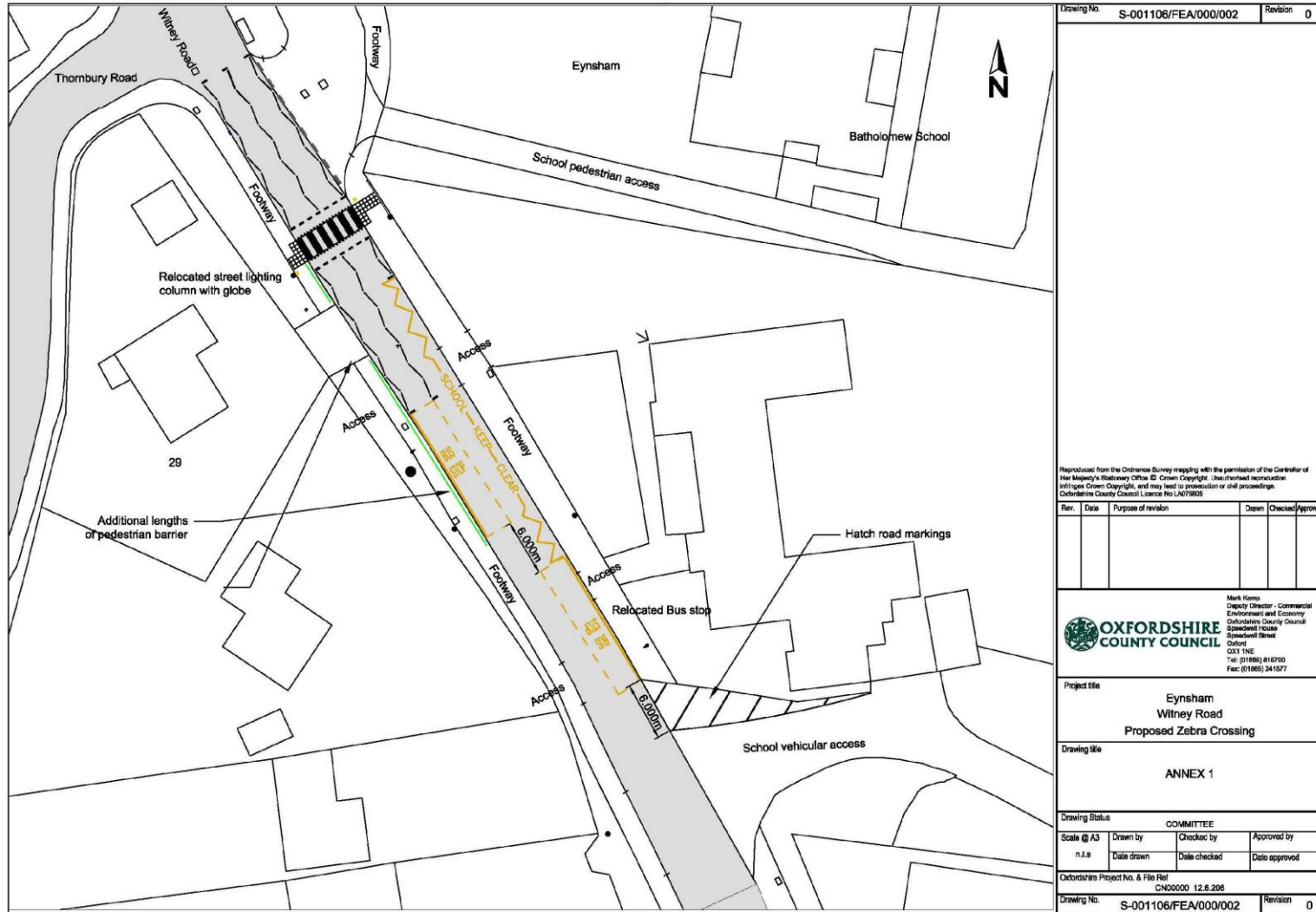

Drawing No. S-001106/FEA/000/002 Revision 0

Reproduced from the Ordnance Survey mapping with the permission of the Controller of Her Majesty's Stationery Office. © Crown Copyright. Unauthorised reproduction infringes Crown Copyright, and may lead to prosecution or civil proceedings. Oxfordshire County Council Licence No LA079805

Rev.	Date	Purpose of revision	Drawn	Checked/Approved

Mark Kemp
 Deputy Director - Commercial
 Environment and Economy
 Oxfordshire County Council
 Speedwell House
 Speedwell Rise
 Oxford
 OX1 1NE
 Tel: (01865) 816700
 Fax: (01865) 241977

Project title
**Eynsham
 Witney Road
 Proposed Zebra Crossing**

Drawing title
ANNEX 1

Drawing Status			
COMMITTEE			
Scale @ A3	Drawn by	Checked by	Approved by
n.i.s	Date drawn	Date checked	Date approved

Oxfordshire Project No. & File Ref
 CN00000 12.6.206

Drawing No. S-001106/FEA/000/002 Revision 0

RESPONDENT	SUMMARISED COMMENTS
County Councillor Charles Mathew	Supports the proposal
Bartholomew School	<p>The justification for the proposed zebra crossing on Witney Road near the pedestrian access to the main school site is manifestly clear and overwhelming in its reasoned common sense.</p> <p>It might be argued that students should be patient and cross the road carefully; this is true. However the volume of traffic makes this almost impossible to do and asking hundreds of students to wait patiently for enough gaps in traffic is both naïve and unrealistic. The traffic situation has got worse over the years as traffic density has increased.</p>
Thames Valley Police	Thames Valley Police have no objection to the zebra crossing.
West Oxfordshire District Council	The Local Planning Authority raises no objection to the proposal. The proposed crossing point would appear an appropriate situation for a zebra crossing and will likely have benefits on the highway safety in the local area by reducing speeds of the vehicles.
Eynsham Parish Council	At their meeting of 3 February 2015, Eynsham Parish Council resolved that on the basis of the consultation drawings it does not support the scheme but suggests the crossing be moved 20 metres south. In the knowledge that there are discussions underway regarding moving the south bound bus stop.
Resident of property adjacent to proposed crossing on Witney Road	<p>This is a 24 hour, 7-day, 52 week solution to a 1 (or maybe 2) hour, 5-day, 40(approx) week possible problem.</p> <p>Will all parking now be impossible/illegal outside of this house? Does this mean that our visitors, any delivery vans and postmen will be unable to park outside of this house?</p> <p>I was in favour of the once-mooted traffic calming that had been proposed for Witney Road - traffic certainly frequently travels at excessive speed in this road. This proposal is unlikely to make any contribution to slowing traffic.</p> <p>When school buses are waiting for their passengers they park on the carriageway and will typically obscure the planned location of this zebra crossing and the presence of this</p>

CMDE5

	crossing may in fact put children in more danger due to this very fact.
Resident of Witney	The proposed crossing is an unnecessary expenditure for the council. The position means that it will not be used by the majority of children travelling to school. The crossing would cause congestion which could lead to incidents as children took chances cutting through traffic. Simply reducing the speed limit to 20mph would reduce the risk of accident.
Two Residents of Thornbury Road	Do not think that there should not be a Zebra crossing on Witney Road. The children that attend Bartholomew school are all aged eleven or over and children of this age should have learnt how to cross a road safely. We think there are much better things that council money could be spent on.
Resident of Witney	It is not necessary to build a Zebra crossing outside Bartholomew School in Witney Rd, Eynsham and a waste of taxpayers money as the recently installed warning lights for motorists are more than adequate.
Resident of Willows Edge	One zebra crossing on Witney Road may not improve the safety of children making their way to Bartholomew Road due to the volume of people using the crossing at peak times. Two crossings dispersed along Witney Road (one near the lay by and one further up toward the A40) may be better. If all those wishing to cross the road are channelled to a zebra crossing the pavements would become a no go area for pedestrians not wishing to cross. A much better and perhaps cheaper solution to improve safety for all access points to the school would be to reduce (and police) the village speed limit to 20mph.
No address given	Yes, please do out in a zebra crossing on the Witney Road - it is very much needed.
Resident of Botley	I would like to express my strong support for this scheme. I have two children who travel to Bartholomew school by bus; such a crossing would enhance their safety as they walk to and from the bus stop and school entrance.
Resident of Willow Edge	I am in favour of the new zebra crossing, not only for my son, who attends Bartholomew School, and has to cross the road to get there twice or more a day, but also for myself as a wheelchair user. I take that route most days. It seems to me that traffic along Witney Road leaving Eynsham travels too fast a 20 mile an hour limit throughout the village is a must.

CMDE5

Resident of Willow Edge	Just to say that I fully support the plan to install a zebra crossing close to Bartholomew School on Witney Road, Eynsham.
Resident of Willow Edge	Very good idea - we live nearby and would appreciate a crossing there. It is not just Bartholomew School children who need to cross safely.
No address given	I think the zebra crossing is a very good idea. My children use the bus stop each morning and it would give them a much safer way to cross to get to the school entrance
No address given	I am writing as a parent of 2 children who both attend Bartholomew School Eynsham. I would like to give my wholehearted support to the proposed plan for a zebra crossing.
No address given	I think that the installation of a crossing outside Bartholomew School in Eynsham is very good idea and long overdue!
Resident of Thornbury Road	I think it a very good idea to put a zebra crossing at that location. It will have the effect of instilling discipline in both children and adults to cross at that point. It will also perhaps curb the excesses of the "speed merchants" to slow down. Drivers of all ages see that stretch of the road as a place where they can put their foot down after negotiating the narrow section of Acre End Street in the centre of the village and the speed humps along the rest of Acre End Street.
Resident of Witney Road	This proposal appears to be an excellent idea. Will a bus stopped at the bus stop have an effect on the visibility of the Zebra crossing?
Resident of Witney Road	Very much for the proposal, but does not think it goes far enough. Very concerned about the speed of cars travelling along the road, particularly on the bend (not shown on the map), which this will not address. Recently the speed limit was reduced to 20mph when warning signs flash, very few cars adhere to this. Would prefer a whole road speed reduction scheme, with speed bumps strategically placed along the road.
Resident of Witney Road	Welcomes the crossing
Resident of Thornbury Road	Supports the crossing

CMDE5