

- NOTES**
- DRAWING IS BASED ON TOPOGRAPHICAL SURVEY SUPPLIED BY AMEC FOSTER WHEELER (AFW) AND WAS LATER ENRICHED BY ADDITIONAL TOPOGRAPHICAL INFORMATION.
  - EXISTING INFRASTRUCTURE IS INDICATED IN THE BACKGROUND OF THESE DRAWINGS. COLOURS SHOWN IN THESE DRAWINGS ARE INDICATIVE AND SHOULD NOT BE CONFUSED WITH THOSE OF FINISHED SURFACES.
  - THE EXISTING HIGHWAY BOUNDARY IS SHOWN ON DRAWINGS AND INDICATED BY THE PURPLE DASHED LINE.
  - THE RED LINE BOUNDARY IS SHOWN ON DRAWINGS AND INDICATED BY THE RED SOLID LINE.
  - THE LOCATION OF NEW STATUTORY AUTHORITY COVERS WITHIN THE FOOTWAY AND CARRIAGEWAY WILL BE DETERMINED ONCE UTILITY DIVERSIONS ARE COMPLETED.
  - FLUSH KERBS WILL BE INTRODUCED ALONG THE GRASSED SURFACE WATER CHANNEL. THESE WILL BE PAIRED WITH A 300MM HARD STRIP TO MAINTAIN THE INTEGRITY OF THE PROPOSED SWALES AND INCREASE SAFETY FOR ROAD USERS.
  - REFER TO DRAWING UND-ACM-HGN-E2\_EW\_ZZ\_ZZ-DR-CH-0101 FOR FURTHER INFORMATION ON THE PROPOSED UNDERPASS.
  - PLEASE REFER TO INDIVIDUAL SERIES DRAWINGS FOR FURTHER DETAIL REGARDING THE STRUCTURES, DRAINAGE, LIGHTING, LANDSCAPE AND 3D DESIGN. INDICATIVE DESIGN ONLY IS DISPLAYED ON THESE GENERAL ARRANGEMENT DRAWINGS.
  - SIGNS AND LIGHTING COLUMNS LOCATED IN THE SUP WILL NEED TO BE RELOCATED AS PART OF THE NEXT STAGE OF DESIGN SIGN LOCATION IS INDICATIVE. FURTHER DETAILS PROVIDED IN THE 1200 SERIES DRAWINGS.
  - PHOTO LUMINESCENT STUDS (ECO-DISK OR SIMILAR APPROVED) TO BE LAID AT REGULAR INTERVALS ALONG BOTH SIDES OF THE NEW SHARED USE FACILITY TO HIGHLIGHT THE EXTENTS OF THE PATH TO USERS DURING HOURS OF DARKNESS.
  - VRS DESIGN IS BASED ON A RRRAP ASSESSMENT AND LOCAL ROAD RISK ASSESSMENT FOR HIGH AND LOW SPEED SECTIONS RESPECTIVELY. DESIGN IS SUBJECT TO CHANGE WITH DETAILS AND MANUFACTURE LENGTHS TO BE CONFIRMED AT A LATER DESIGN STAGE.
  - FLOOD MITIGATION DESIGN IS EXCLUDED FROM THESE DRAWINGS DUE TO ONGOING MODELLING WORK.
  - SCREENING TO REDUCE VISIBILITY TO THE RIGHT SHOULD BE AT LEAST 2m IN HEIGHT TO BLOCK THE VIEW OF ROAD USERS.
  - IMPLEMENTATION OF PEDESTRIAN GUARD RAIL (PGR) AT THE TOUCAN CROSSING'S AT HORSEMERE LANE AND CASSINGTON JUNCTION IS SUBJECT TO A PGR ASSESSMENT.
  - FOR FURTHER DETAILS ON LAND REQUIREMENTS AND OWNERSHIP PLEASE REFER TO BUS-ACM-HGN-E2\_EW\_ZZ\_ZZ-DR-CH-0066-0087.

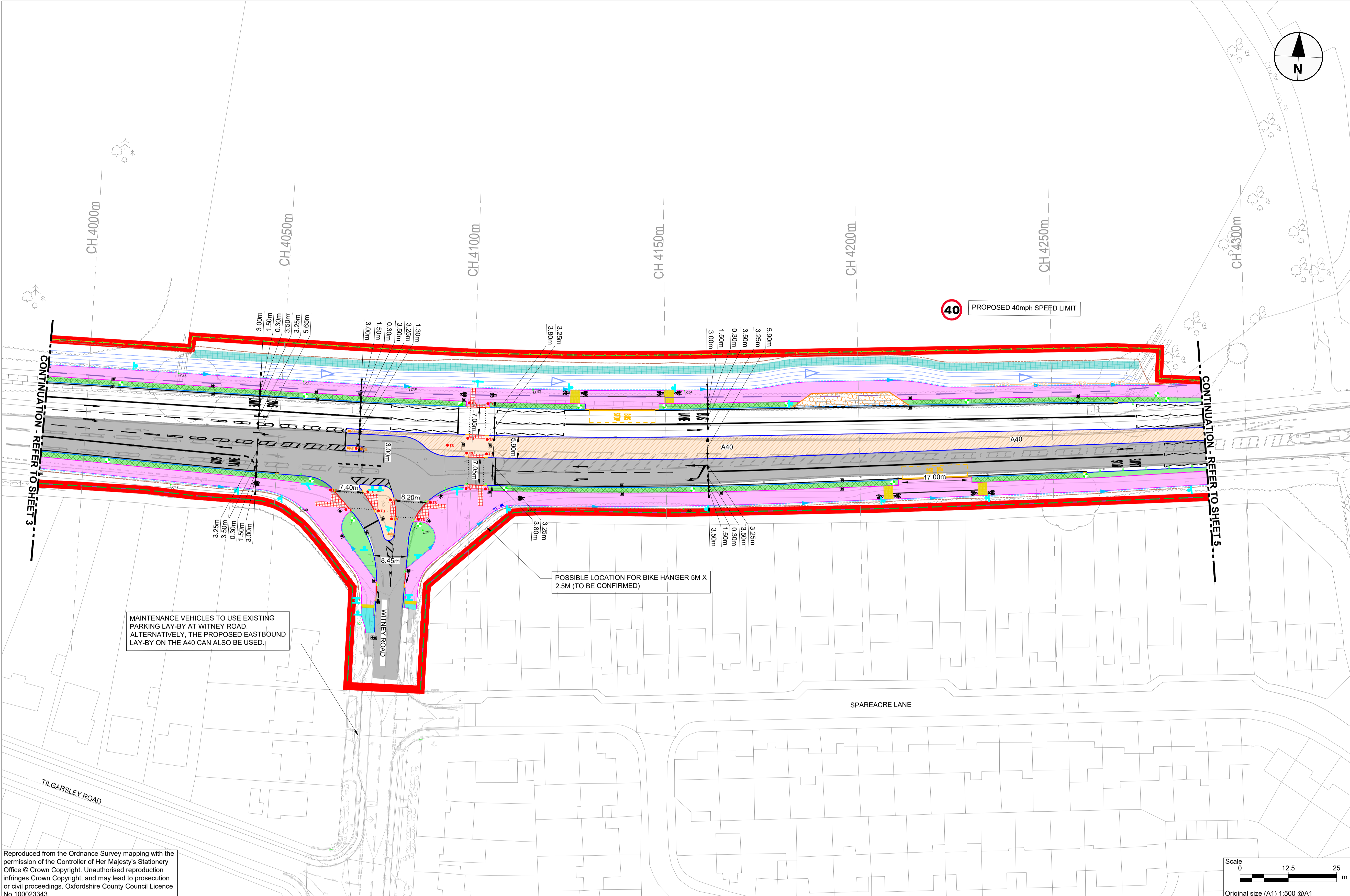

MAINTENANCE VEHICLES TO USE EXISTING PARKING LAY-BY AT WITNEY ROAD. ALTERNATIVELY, THE PROPOSED EASTBOUND LAY-BY ON THE A40 CAN ALSO BE USED.

POSSIBLE LOCATION FOR BIKE HANGER 5M X 2.5M (TO BE CONFIRMED)

40 PROPOSED 40mph SPEED LIMIT

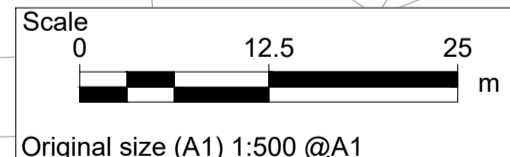

Reproduced from the Ordnance Survey mapping with the permission of the Controller of Her Majesty's Stationery Office © Crown Copyright. Unauthorised reproduction infringes Crown Copyright, and may lead to prosecution or civil proceedings. Oxfordshire County Council Licence No 100023343.

KEY	
CHAINAGE STRING	PROPOSED FENCE LINE AT NEW HIGHWAY BOUNDARY LOCATIONS
EXISTING HIGHWAY BOUNDARY	PROPOSED 1.5m FULL HEIGHT FENCING
PROPOSED HIGHWAY BOUNDARY	PROPOSED 0.6m KNEE HEIGHT FENCING
PROPOSED KERB 140mm UPSTAND. DETAILS TBC	EXISTING PUBLIC RIGHT OF WAY (FOOTPATH)
PROPOSED KERB 125mm UPSTAND. DETAILS TBC	EXISTING PUBLIC RIGHT OF WAY (RESTRICTED BYWAY)
PROPOSED 45° SPLAY KERB DETAILS TBC	EXISTING PUBLIC RIGHT OF WAY (BRIDLEWAY)
PROPOSED FLUSH KERB AT CROSSING (0-6mm). DETAILS TBC	PROPOSED COMBINED VRS AND FENCING
PROPOSED EDGING. DETAILS TBC	PROPOSED SCREENING
PROPOSED EDGING AT VEHICLE CROSS OVER	PROPOSED VEHICLE RESTRAINT SYSTEM DETAILS TBC.
PROPOSED KERB 75mm UPSTAND. DETAILS TBC	PROPOSED EARTHWORKS EXTENTS
PROPOSED FLUSH KERB (0mm). DETAILS TBC	PARK AND RIDE BOUNDARY AS PER PREVIOUS PLANNING APPROVAL
PROPOSED TRANSITION KERB. DETAILS TBC	PROPOSED A40 SITE COMPOUND AREA
PROPOSED BULL-NOSED KERB. DETAILS TBC	PROPOSED RAMP DOWN TO SUBWAY - SOUTH SIDE. DETAILS TBC
REDLINE BOUNDARY	PROPOSED LANDSCAPING / EARTHWORKS / RETAINING FEATURES. LOCATION INDICATIVE. DETAILS TBC
	PROPOSED ADDITIONAL FOOTWAY / CYCLEWAY CONNECTION. DETAILS TBC
	SSSIS/AC LOCATION
	PROPOSED 2m PLANTING AREA
	PROPOSED NCNS LINK LOCATION
	PROPOSED SUBWAY PUMPING STATION
	PROPOSED SHARED USE FACILITY / FOOTWAY
	PROPOSED TRAFFIC ISLAND (HARD SURFACE). DETAILS TBC
	PROPOSED TRAFFIC ISLAND (LANDSCAPING AREA). DETAILS TBC
	PROPOSED BUFF TACTILE PAVING
	PROPOSED RED TACTILE PAVING
	PROPOSED GRASS VERGE
	PROPOSED GRASSED SURFACE WATER CHANNEL OVERLAYING ATTENUATION TRENCH. DETAILS TBC
	PROPOSED CONCRETE SUBWAY BOX - MODULAR CONSTRUCTION. DETAILS TBC
	PROPOSED RAMP DOWN TO SUBWAY - NORTH SIDE. DETAILS TBC
	PROPOSED VEHICLE CROSS OVER
	PROPOSED MAINTENANCE LAY-BY. DETAILS TBC
	PROPOSED CARRIAGEWAY RESURFACING DETAILS TBC.
	PROPOSED CARRIAGEWAY FULL DEPTH RECONSTRUCTION DETAILS TBC
	PROPOSED SPEEDTABLE - 25mm
	PROPOSED SPEEDTABLE - 75mm
	PROPOSED SPEEDTABLE - 30mm
	1000mm OVERRUN STRIP
	BRIDGE PARAPETS
	PROPOSED PEDESTRIAN DETERRENT PAVING
	PROPOSED PAVEMENT RESURFACING
	EXISTING CULVERT
	PROPOSED STRUCTURE WIDENING
	PROPOSED YELLOW BUS STOP ROAD MARKINGS
	PROPOSED WHITE ROAD MARKINGS. DETAILS TBC
	PROPOSED TRAFFIC SIGNAL POLE
	PROPOSED LIGHTING COLUMN
	PROPOSED TRAFFIC SIGN (PS) MOUNTED ON NEW POST
	PROPOSED TRAFFIC SIGN (PS) MOUNTED BACK TO BACK ON NEW POST
	PROPOSED WAY FINDING SIGN (PS) MOUNTED ON NEW POST
	PROPOSED REFLECTIVE BOLLARD
	PROPOSED ROAD STUDS
	PROPOSED QUADRANT KERB. DETAILS TBC
	SUBWAY PUMP
	EXISTING ELECTRIC SUB-STATION
	PROPOSED SUBWAY ABUTMENTS AND WINGWALLS. DETAILS TBC
	PROPOSED SHEET PILING
	PROPOSED CHAMBER ACCESS POINT
	PROPOSED TRAFFIC SIGNALS CONTROLLER AND ELECTRICITY SUPPLY PILLAR
	PROPOSED DITCH AND DIRECTION OF FLOW
	BACK OF FOOTWAY FILTER TRENCH WITH UNDERDRAIN
	PROPOSED GULLY GRATE
	PROPOSED INSPECTION CHAMBER AND SILT TRAP DETAILS TBC
	PROPOSED BRIDGE ABUTMENTS DETAILS TBC
	PROPOSED GATE DETAILS TBC

**FOR PLANNING**

**ISSUE/REVISION**

P01	20/04/21	FIRST ISSUE
P02	25/06/21	SECOND ISSUE
P03	26/10/21	THIRD ISSUE
P04	11/11/21	FOURTH ISSUE
P05	16/11/21	ISSUED FOR PLANNING
P06	06/12/21	OCC/GH COMMENTS ADDRESSED
P07	13/12/21	VALIDATION COMMENTS
I/R	DATE	DESCRIPTION

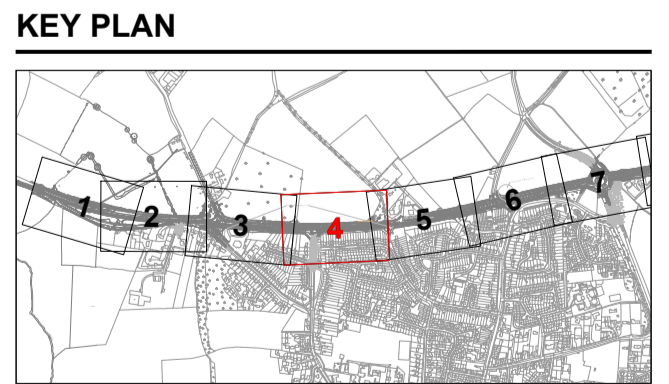

**SHEET TITLE**  
**A40 IBL ELEMENT 2**  
**GENERAL ARRANGEMENT**  
**SHEET 4 OF 23**

**SHEET NUMBER**

Project Number	Originator	Volume	Revision
BUS	- ACM	- HGA	P07
E2_EW_ZZ_ZZ	- DR	- CH	- 0104
Location	I Type	I Role	I Number

This drawing has been prepared for the use of AECOM's client. It may not be used, modified, reproduced or relied upon by third parties, except as agreed by AECOM or as required by law. AECOM accepts no responsibility, and denies any liability whatsoever, to any party that uses or relies on this drawing without AECOM's express written consent. All measurements must be obtained from the stated dimensions.