

IT IS ASSUMED THAT ALL WORKS ON THIS DRAWING WILL BE CARRIED OUT BY A COMPETENT CONTRACTOR WORKING, WHERE APPROPRIATE, TO AN APPROPRIATE METHOD STATEMENT.

THIS DRAWING IS TO BE USED ONLY FOR THE PURPOSE OF ISSUE THAT IT WAS ISSUED FOR AND IS SUBJECT TO AMENDMENT.

- NOTES:
1. ALL DIMENSIONS ARE IN METRES UNLESS OTHERWISE STATED
 2. DO NOT SCALE FROM DRAWING.
 3. THE INFORMATION ON THIS PLAN IS GIVEN WITHOUT OBLIGATION OR WARRANTY. NO LIABILITY OF ANY KIND WHATSOEVER IS ACCEPTED BY AECOM FOR ANY ERRORS OR OMISSIONS.
 4. DRAWING IS BASED ON ORDNANCE SURVEY MAPPING AND TOPOGRAPHICAL SURVEY
 5. ITEMS IN GREY (APART FROM SOLID HATCHING) REPRESENT EXISTING INFRASTRUCTURE AND ARE TO REMAIN UNLESS STATED OTHERWISE.
 6. PONDS INDICATED ON DRAWINGS ARE ALSO REFERRED TO AS MARSH AND WET GRASSLAND WITHIN LANDSCAPE DRAWINGS.
 7. SEE LANDSCAPE DRAWINGS FOR THE NEW LANDSCAPE FEATURES AND EXISTING TREE RETENTION DETAILS.

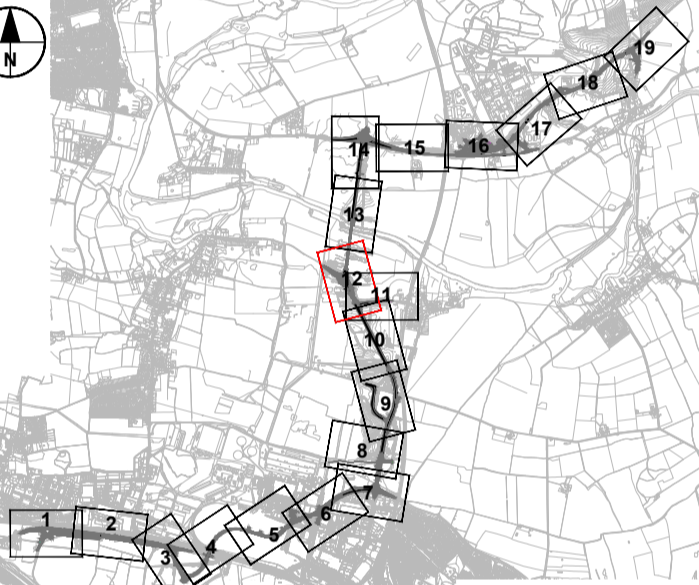
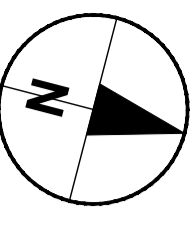

VERSION	BY	DATE	SUFFIX
FIRST VERSION	AZ	21/07/21	P01
	KC		
SECOND VERSION	AZ	09/09/21	P02
	DR		
THIRD VERSION	RBF	13/06/22	P03
	AA		
REVISION DETAILS		By	Date
	Check		

Purpose of issue
SUITABLE FOR APPROVAL

Client
OXFORDSHIRE COUNTY COUNCIL

Project Title
DIDCOT GARDEN TOWN HOUSING INFRASTRUCTURE FUND (HIF 1)

Drawing Title
DIDCOT TO CULHAM RIVER CROSSING GENERAL ARRANGEMENT SHEET 12 OF 19

Designed	Drawn	Checked	Approved	Date
AZ	RBF	AA	AGB	13/06/22

Internal Project No. 60632497
Scale @ A1 1:1000
Discipline Town & Country Planner

THIS DOCUMENT HAS BEEN PREPARED PURSUANT TO AND SUBJECT TO THE TERMS OF AECOM'S APPOINTMENT BY ITS CLIENT. AECOM ACCEPTS NO LIABILITY FOR ANY USE OF THIS DOCUMENT OTHER THAN BY ITS ORIGINAL CLIENT OR FOLLOWING AECOM'S EXPRESS AGREEMENT TO SUCH USE, AND ONLY FOR THE PURPOSES FOR WHICH IT WAS PREPARED AND PROVIDED.

AECOM
63-77 Victoria Street
St Albans
Herts
AL1 3ER
Tel: +44 (0) 172 7535 000
www.aecom.com



Work Package ID	Volume	Type	Number	Rev
GEN_PD-ACM-GEN-DGT_ZZ_ZZ_ZZDR-T	-0012			P03
Originator	Location	Role		

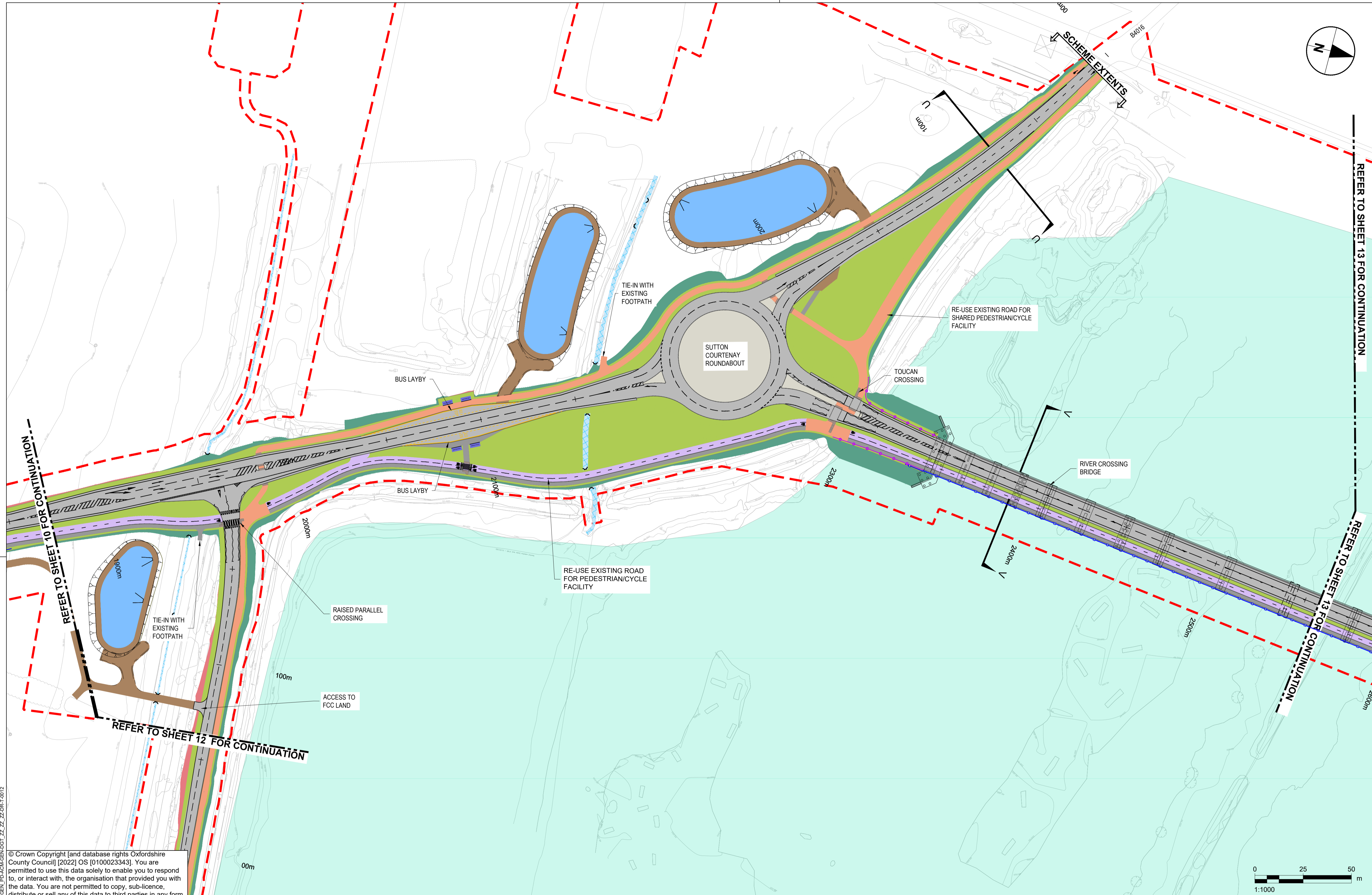

© Crown Copyright [and database rights Oxfordshire County Council] [2022] OS [0100023343]. You are permitted to use this data solely to enable you to respond to, or interact with, the organisation that provided you with the data. You are not permitted to copy, sub-licence, distribute or sell any of this data to third parties in any form.

KEY

FOOTWAY	POND
CYCLEWAY	GRASSED SURFACE WATER CHANNEL
SHARED USE FOOTWAY	WATER BODY
CARRIAGEWAY	WETLAND AREA
OVERRUN AREA	SWALE / FILTER DRAIN
GRASS VERGE / LANDSCAPED AREA	PROPOSED DITCH
EMBANKMENT / LANDSCAPED AREA	EXISTING DITCH
BUFFER STRIP	FLOOD ATTENUATION AREA
CLEAR ZONE	VEHICLE CROSS OVER
CUTTING	HEADWALL
TRAFFIC ISLAND	WATERCOURSE
MAINTENANCE ACCESS / MAINTENANCE LAY-BY	NOISE BARRIER
ROAD MARKINGS	VEHICLE RESTRAINT SYSTEM BARRIER
REDLINE BOUNDARY	BRIDGE STRUCTURE

Plot Date: 29 June 2022, 17:55:05
 File Name: C:\WORKING\PROJECTS\GEN_PD-ACM-GEN-DGT_ZZ_ZZ_ZZDR-T-0012