

CABINET MEMBER FOR ENVIRONMENT – 13 OCTOBER 2016

PROPOSED TOUCAN CROSSING – A423 SOUTHAM ROAD, BANBURY

Report by Interim Director of Environment & Economy (Commercial)

Introduction

1. This report presents an objection and comments received in the course of the statutory consultation on the proposal to install a toucan crossing on the A423 Southam Road approximately 100 metres north of its junction with Dukes Meadow Drive, Banbury.

Background

2. The toucan crossing (a signal controlled crossing for use by both pedestrians and pedal cyclists) is proposed to help improve pedestrian and pedal cyclist safety in light of the development of adjacent land for residential purposes. The location and detail of these proposals is shown at Annex 1 and Annex 2.

Consultation

3. The formal consultation on the proposals was carried out between 19 May and 10 June 2016. A public notice was advertised in the Banbury Guardian on 19 May, and street notices were placed at intervals along the road in the immediate vicinity. An email was sent to statutory consultees, including Thames Valley Police, the Fire & Rescue Service, Ambulance service, Town & District Councils and the relevant local County Councillors (including those representing the other neighbouring divisions).
4. One objection to the proposal was received during the consultation period, and this – along with other comments received as part of the consultation – are summarised at Annex 3. Copies of all the responses received are available for inspection in the Members' Resource Centre.
5. Thames Valley Police had no objection to the proposal, but did raise some concerns regarding the current conditions at the site.
6. Councillor Beal (the local Member for Banbury Grimsbury & Castle) indicated his support for the proposals.

Objections and concerns

CMDE4

Contact Officers:
September 2016

David Tole 07920 084148

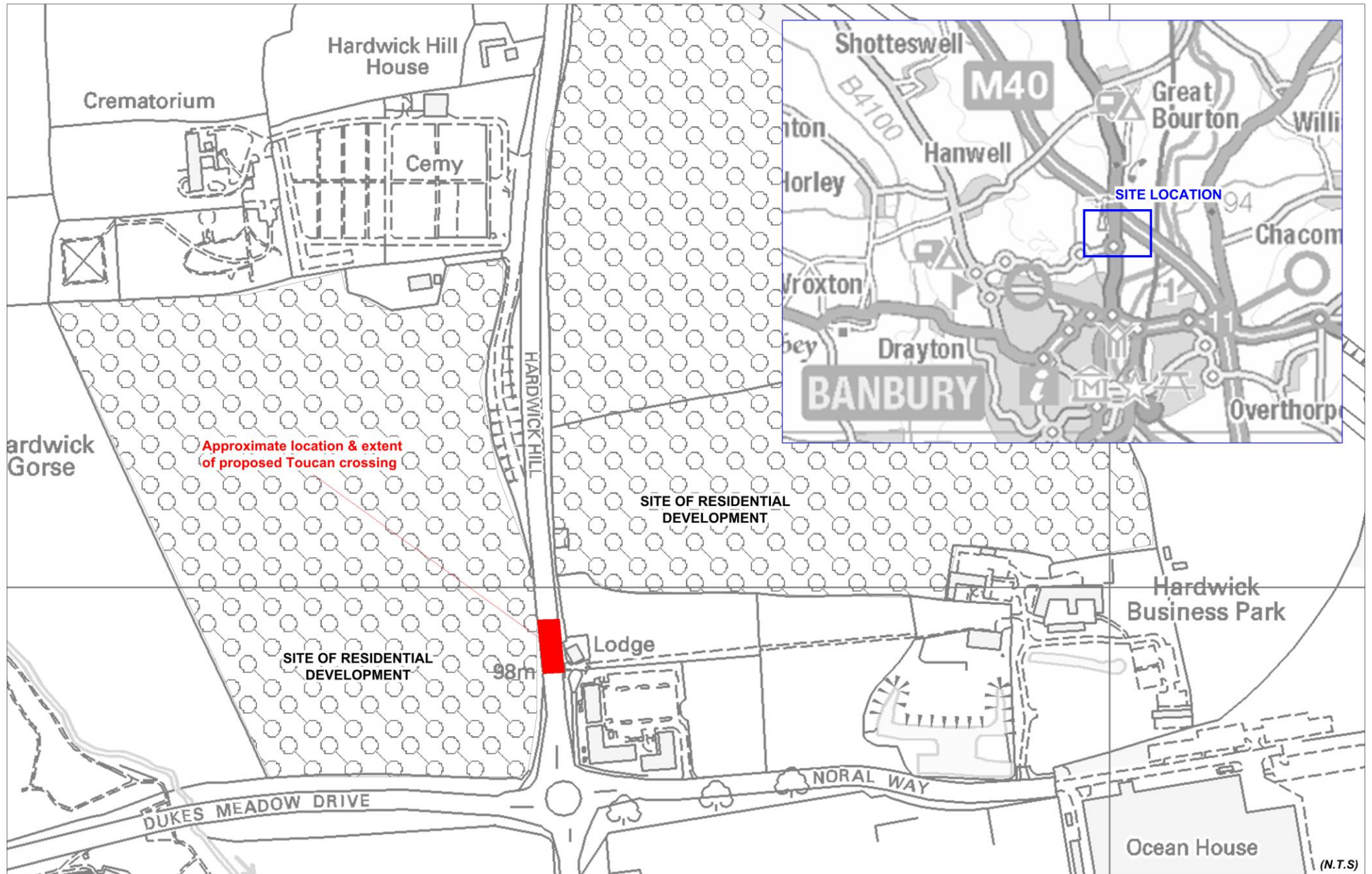

Reproduced from the Ordnance Survey mapping with permission of the Controller of Her Majesty's Stationery Office © Crown Copyright
 Unauthorised reproduction infringes Crown Copyright and may lead to prosecution or civil proceedings.
 Oxfordshire County Council. © Crown Copyright and database rights 2016. 100023343



Date drawn: 10/05/2016
 Drawn by: CJM

Map centre:
 easting. 445656, northing. 243118

PANDORA LAND ACCESS

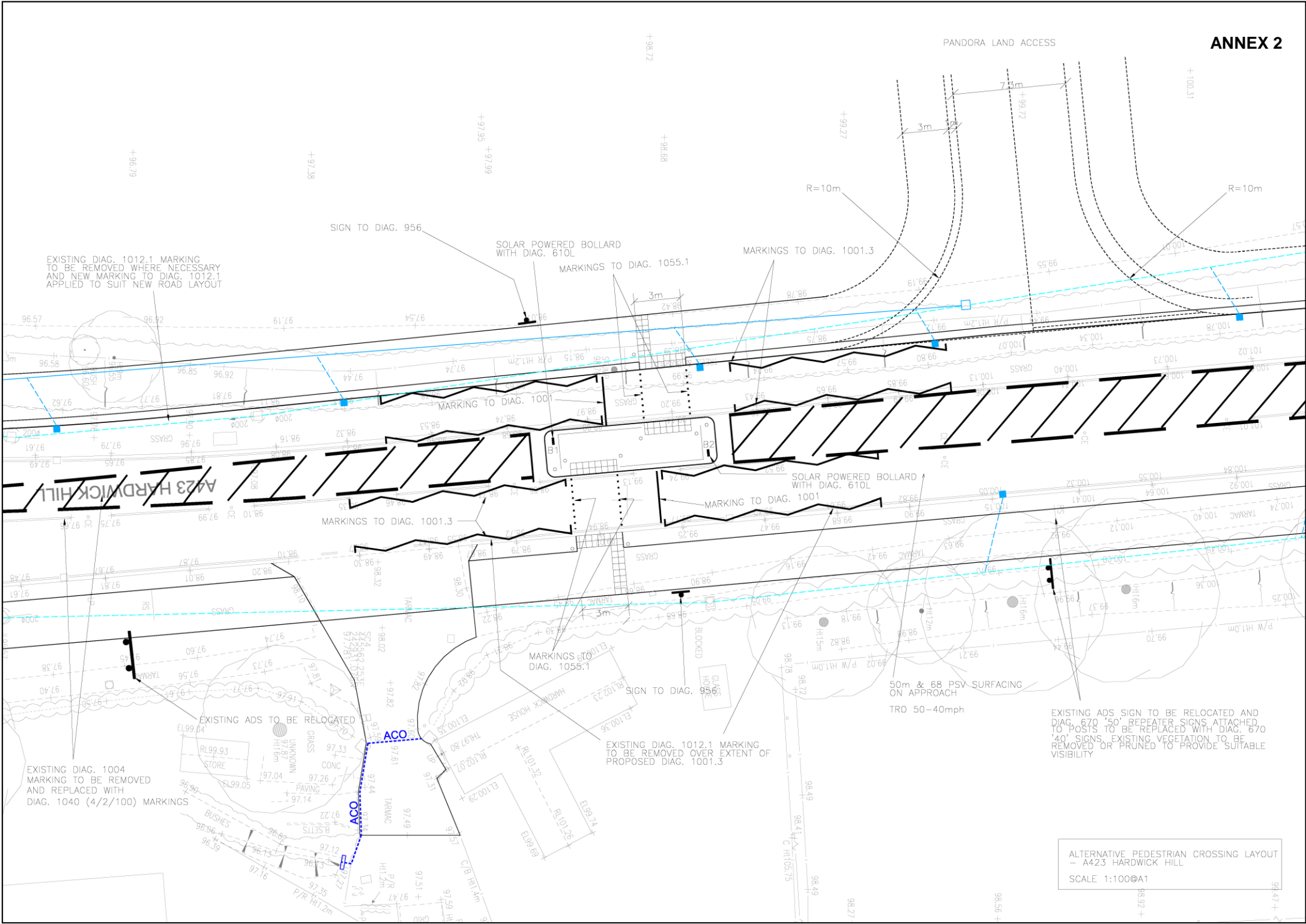

EXISTING DIAG. 1012.1 MARKING TO BE REMOVED WHERE NECESSARY AND NEW MARKING TO DIAG. 1012.1 APPLIED TO SUIT NEW ROAD LAYOUT

SIGN TO DIAG. 956

SOLAR POWERED BOLLARD WITH DIAG. 610L

MARKINGS TO DIAG. 1055.1

MARKINGS TO DIAG. 1001.3

MARKING TO DIAG. 1001.3

MARKING TO DIAG. 1001.3

SOLAR POWERED BOLLARD WITH DIAG. 610L

MARKINGS TO DIAG. 1055.1

EXISTING DIAG. 1012.1 MARKING TO BE REMOVED OVER EXTENT OF PROPOSED DIAG. 1001.3

50m & 68m PSV SURFACING ON APPROACH
TR0 50-40mph

EXISTING ADS SIGN TO BE RELOCATED AND DIAG. 670 '50' REPEATERS SIGNS ATTACHED TO POSTS TO BE REPLACED WITH DIAG. 670 '40' SIGNS. EXISTING VEGETATION TO BE REMOVED OR PRUNED TO PROVIDE SUITABLE VISIBILITY

EXISTING ADS TO BE RELOCATED

EXISTING DIAG. 1004 MARKING TO BE REMOVED AND REPLACED WITH DIAG. 1040 (4/2/100) MARKINGS

ALTERNATIVE PEDESTRIAN CROSSING LAYOUT - A423 HARDWICK HILL
SCALE 1:100@A1

ANNEX 3

RESPONDENT	SUMMARISED COMMENTS
(1) Thames Valley Police	<p>No objection – with the following comments:</p> <ul style="list-style-type: none"> ▪ Accepting the proposed crossing in the current state of the road character and condition is a risk that the highway authority must take, especially in view of the likely developer contribution towards construction costs. ▪ This however is not considered best practice when establishing a road safety feature, where key infrastructure has not been completed that could potentially affect its safe operation and use. ▪ The sightlines are currently good and inter-visibility is not currently considered a safety factor. The crossing is located close to one residential property and a reasonable distance north of the roundabout junction. However there is the potential for rear end shunt accidents when the light crossing lights are red for traffic.
(2) Local County Councillor	<p>Supports – with the following comments:</p> <ul style="list-style-type: none"> ▪ Seems to be a very sensible thing to put a crossing on this road.
(3) Resident, (Southam Road, Banbury)	<p>Objects – with the following comments:</p> <ul style="list-style-type: none"> ▪ There will be pedestrians continually stood right outside our bedroom window & garden 24 hours 7 days per week. ▪ When pedestrians press the button to change the lights and stop the traffic to successfully cross the road safely, this will be a continuous beeping and flashing of the traffic lights which come with a toucan crossing able to be heard and seen whilst in our house at all hours of the day with no rest. ▪ The traffic stopping directly outside our house will also poses a high noise problem and at unsociable

CMDE4

	<p>hours of the day especially lorries.</p> <ul style="list-style-type: none">▪ Please also consider the amount of extra cars which will be travelling up & down the Southam Road. The speed limit is 40 hardly anyone adhering to this as it stands now. There would be an accident waiting to happen if a toucan crossing was installed in the proposed location.▪ The Toucan Crossing will also cause significant traffic problems for us & our neighbours at Hardwick house turning right and left outside of the driveway.▪ These points I have highlighted significantly reduce our privacy as the height of the footpath has been raised for the current housing development being undertaken. I am as you can imagine not happy with the positioning of this proposed toucan crossing.
--	--